

6523 SEWANEE - WEST UNIVERSITY

CLICK ARROWS
TO LAUNCH
PHOTOS OR
VIDEOS

QUARTERS
OVER
GARAGE

OR
GO TO:

AMENITIES TEXT
Detailed
Text Description
of the Features
and Finishes
of this Property

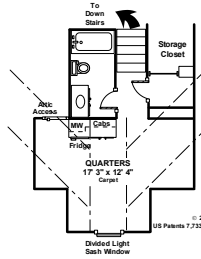
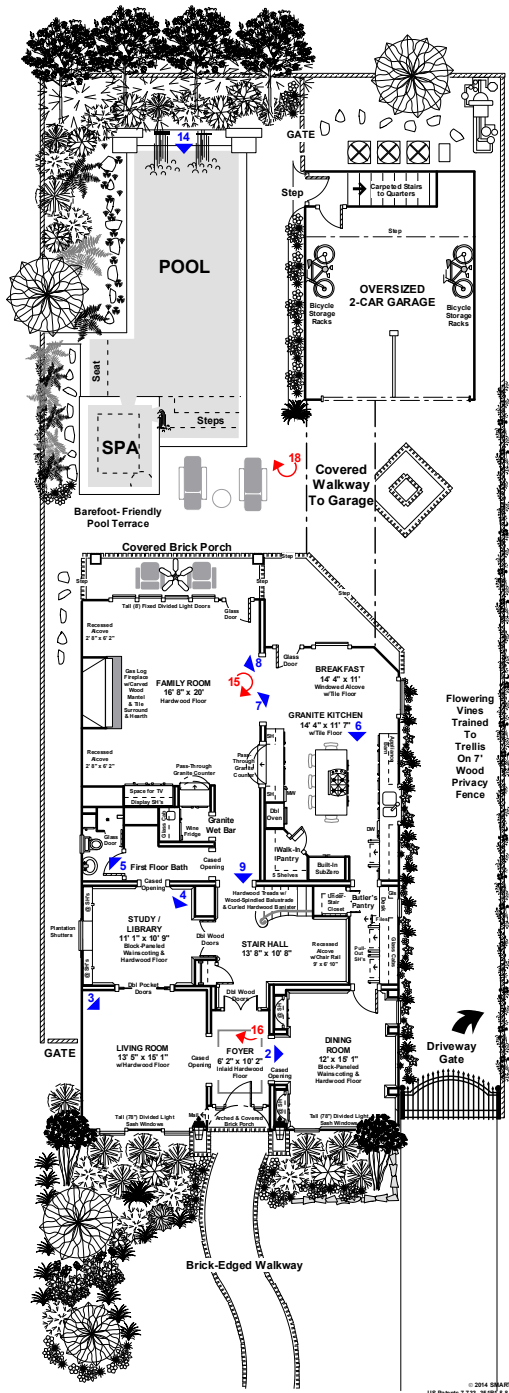

MASTER SUITE PRIVATE COVERED
BALCONY OVERLOOKS POOL
& POOL TERRACE

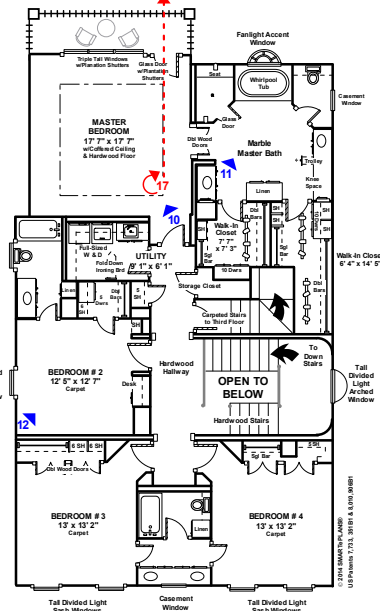

SECOND FLOOR

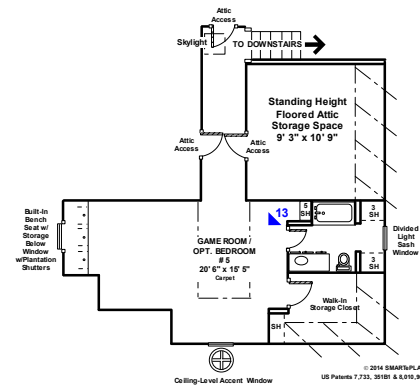

THIRD FLOOR

© 2014 SMARTPLANS®
US Patents 7,732, 351B1 & 8,010,906B1

© 2014 SMARTPLANS®
US Patents 7,732, 351B1 & 8,010,906B1

© 2014 SMARTPLANS®
US Patents 7,732, 351B1 & 8,010,906B1

This floor plan does not calculate, nor purport to represent in any way the total square footage of the property depicted. This is an artistic drawing for marketing purposes only; and is not to be confused with, or used as any sort of property appraisal or survey. This artistic drawing is copyrighted to the artist and does not convey with the sale of the property depicted, and always remains the property of the artist who created it. While every attempt has been made to ensure the accuracy of this floor plan, measurements are approximates and have been rounded for expediency. Errors and omissions may be inadvertently reflected in this artistic drawing. The services, systems and appliances shown in the floor plan have not been tested and no guarantee as to their operating ability, efficiency or if they are indeed included in the sale / lease of the property is implied by this artistic drawing. Purchaser / Leasor should independently validate and verify all information visually depicted here.

© 2014 SMARTPLANS®

US Patent (s) 7,732,351B1 & 8,010,906B1