

42' Hunter 420 Passage

LOA: 43' 5" LWL: 41' 1"
BEAM: 13' 10"
BALLAST: 6700

DISPLACEMENT: 19500
DRAFT: 5' 0"
BRIDGE CLEARANCE: 58' 5"

ENGINE(s): Yanmar
ENGINE(s) HP: 56
FUEL: 60 WATER: 145 HOLDING: 45

The Passage 420 Mirrors the Innovations That Have Evolved Throughout the Hunter Line. Special Features Such as the Powerful B&R Rig, Integrated Cockpit Arch, Mast Struts and Composite Chainplates are all Present on the 420. Center Cockpits are not Usually Known for Performing, but the Passage 420 Surprisingly Breaks the Rules. The Integrated Arch Also Includes Stereo Speakers, Lights and an Attachment for the Overhead Traveler, Keeping the Cockpit Clean. It also Makes the Installation of the Bimini Clear of the Traffic Pattern. Short-handed Sailing is Made Easy with all the Lines Led Aft to the Stopper and the Self-Tailing Winches. Line Organizer Wells Keep it Clean While the Electric Halyard Winch Makes it Effortless to Raise the Main or Send Crew Aloft. The Best Seats in the House Just Got Twice as Good! Hunter's Taffrail Seats Are Always in High Demand. Even Drinkholders are Standard. Custom Stainless Steel Bow and Stern Rails Along with Double Life Lines Make Moving Fore and Aft Safe and Easy.

The Transom is a Work of Art with Two Huge Storage Compartments. One Houses the Generator and the Other Could Store an Inflatable Dinghy or a Couple of Sets of Scuba Gear. A fold-down Swim Ladder and All the Electrical and Cable Television Outlets are Convenient as Well. After Diving, Swimming or Just Lounging on a Secluded Beach, the Hot and Cold Transom Shower Makes for a Quick, Comfortable and Easy Clean-Up. The Dual Roller Pulpit Allows for Two Anchors to Be Deployed Simultaneously.

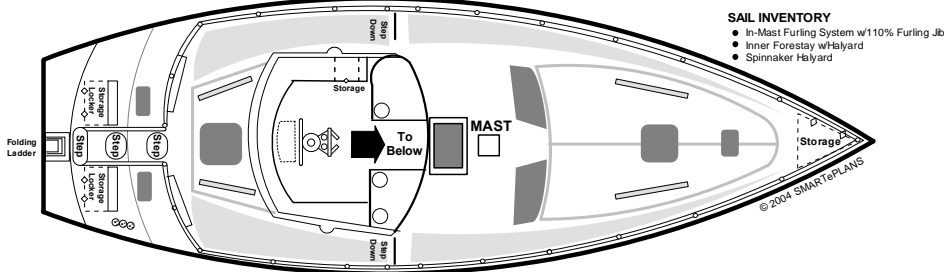

SAIL INVENTORY

- In-Mast Furling System w/110' Furling Jib
- Inner Forestay w/Halyard
- Spinnaker Halyard

ELECTRONICS

The Custom Pedal Allows for Plenty of Electronics Space Because the Engine Instruments Are Located on the Stainless Steel Arch. A Fold-Up Table Makes for Great Entertaining. Mechanical Steering Gives the Skipper Great Control and Feedback

- Digital Knot Meter
- Digital Depth Sounder
- VHF Radio
- Raytheon RL74RC Color Radar/Chart w/GPS
- Autohelm 7000 Autopilot
- Compass

ELECTRICAL

- 12 vdc, 110 Vac
- Batteries
- Inverter
- Dockside Power
- Battery Charger
- Northern Lights Diesel Generator
- Air Conditioning w/ Reverse Cycle Heat

DECK AMENITIES

- Bimini Top
- Enclosure w/ Cover
- Windshield w/ Cover
- Electric Halyard Winch
- Hatch Covers
- Aft Seat Covers
- Flag Halyards
- Stern Rail Seats
- Double Life Lines w/2 Gates
- Anchor
- Swim Platform w/Ladder
- Hot/Cold Pressure Transom Shower
- Dockside Freshwater Hook-Up
- Transom Storage Lockers
- Folding Cockpit Table
- Fenders
- Docklines
- Quickcliver 330 Dinghy
- 8 HP Outboard

MASTER BATH

Corian Covered Vanity and Shower

- Corian Countertops
- Built-in Waste Bin
- 3-Burner Stove w/Oven

GALLEY

- Microwave
- Water Heater
- Refrigerator & Freezer
- Hot/Cold Pressure Water System
- Double Stainless Sink w/ Cutting Board
- Plenty of Storage Cabinets, Overhead Shelving, and Drawers

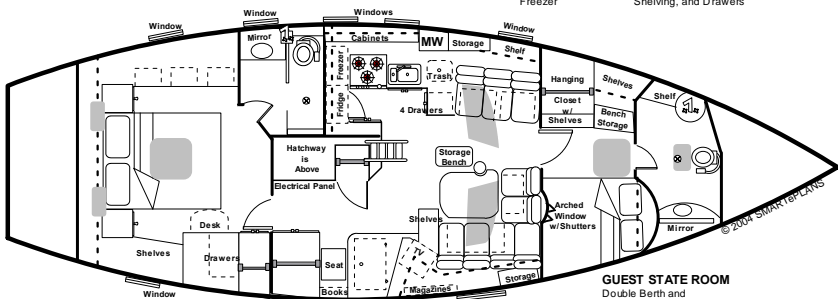

MASTER STATE ROOM

Island Queen Size Berth w/ Inner Spring Mattress, & Night Tables, Drawer Space, Hanging Space and Under Seat Storage as Well. Slide-Out Desk Has Vanity Mirror. Skylights & Portholes Provide Ample Light

NAVIGATION STATION

Houses the Controls to all the Ships Systems & Allows Space for all your Navigational Electronics.

SALON

Large Salon w/ Convertible Dinette & Opposing Settee, Both with UnderSeat Storage. Highly Polished Teak Table TV w/VCR & AMFM Stereo & CD

GUEST STATE ROOM

Double Berth and Private Head w/Shower Hanging Space & Cabinet Shelving and UnderSeat Storage & Skylights

SMARTePLANS

This is a concept drawing, and is not to be confused with, or used as any sort of property appraisal or valuation. While every attempt has been made to ensure the accuracy of this floor plan, measurements are approximates and have been rounded for expediency. The services, systems and appliances shown in the floor plan have not been tested and no guarantee as to their operating ability, efficiency or if they are indeed included in the sale of the property is implied by this concept drawing. © 2004 SMARTePLANS