

911 DAVIS ROAD
WATERFRONT IN LEAGUE CITY

FIRST FLOOR

CLICK
ARROWS
TO LAUNCH
PHOTOS

OR
GO TO:

FLOOR
PLAN
SECOND
FLOOR

OR
GO TO:

AMENITIES TEXT
Detailed Text
Description
of the Features
and Finishes
of this Property

SMARTePLANS®

This floor plan does not calculate, nor purport to represent in any way the total square footage of the property depicted. This is an artistic drawing for marketing purposes only, and is not to be confused with, or used as any sort of property appraisal. The contents and depictions in this artistic drawing and linked amenities text are customized to the client at creation, per their direction. This artistic drawing is copyrighted to the artist and does not convey with the sale of property depicted, but always remains the property of the artist who created it. While every attempt has been made to ensure the accuracy of this floor plan, measurements are approximates and have been rounded for expediency. Errors and omissions may be inadvertently reflected in this concept drawing. The services, systems and appliances shown in the floor plan and linked in the amenities text have not been tested and no guarantee as to their operating ability, efficiency or if they are indeed included in the sale/lease of the property is implied by this concept drawing. Purchaser / Lessor should independently validate and verify all information visually depicted here.

© 2018 SMARTePLANS
US Patent (s) 7,733, 351B1 & 8,01096B1

TREX® PLANKED
BOAT DOCK
ON PIERS

TREX® PLANKED
BOARDWALK ALONG
WATERFRONT
BULKHEAD

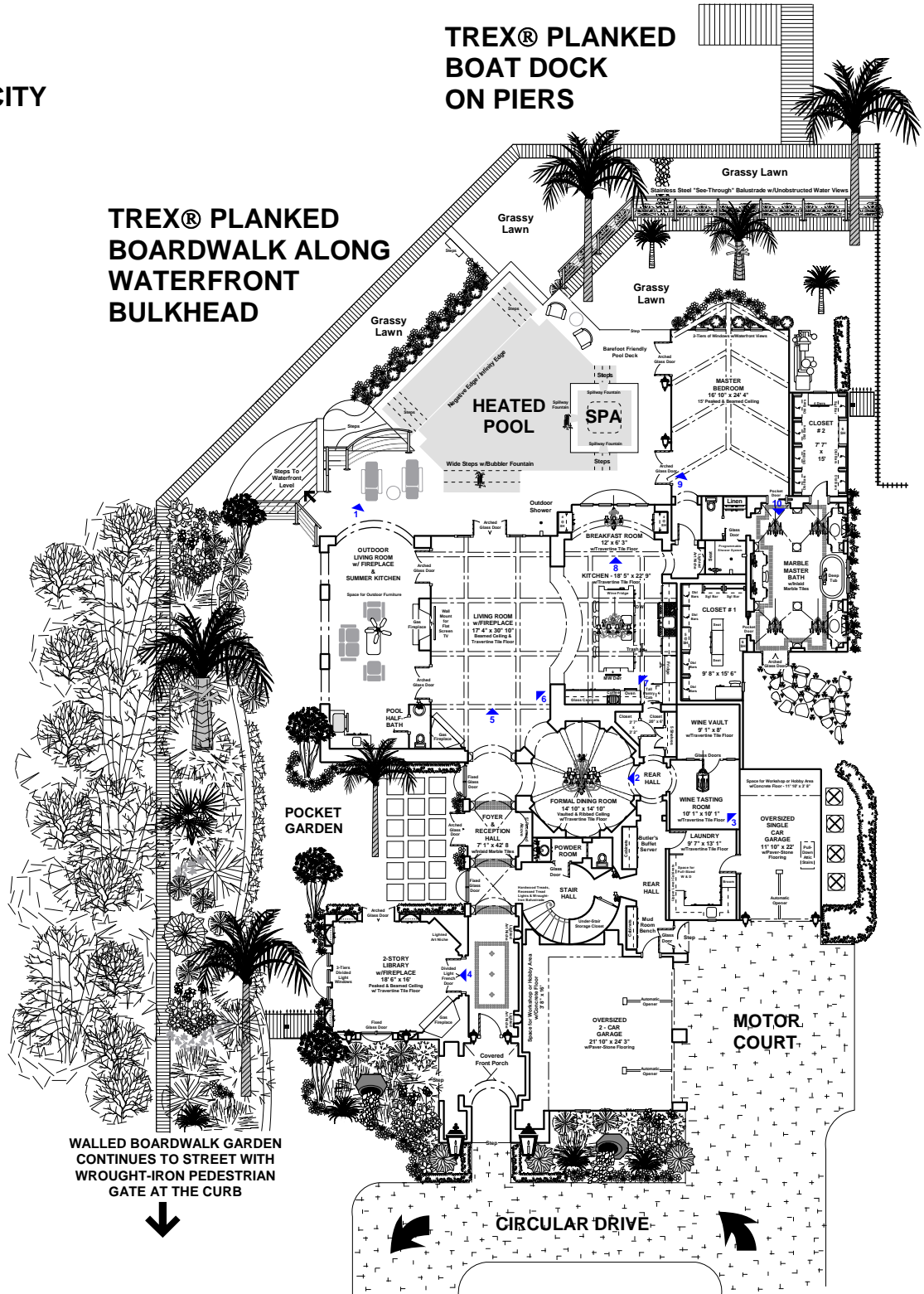

WALLED BOARDWALK GARDEN
CONTINUES TO STREET WITH
WROUGHT-IRON PEDESTRIAN
GATE AT THE CURB

CIRCULAR DRIVE